

FLOOR PLAN - BUILDING A3 to A9



Building	A3 to A6	A7 to A9
Floors	G+14	G+13
Flat Nos.	101, 102, 103, 104 to 1401, 1402, 1403, 1404	101, 102, 103, 104 to 1301, 1302, 1303, 1304
Type	2 BHK	2 BHK
Carpet Area as per RERA	57.30 sq.mt.	57.30 sq.mt.
Balcony	2.90 sq.mt.	2.90 sq.mt.
Utility	2.70 sq.mt.	2.70 sq.mt.
Cupboard Projection	1.90 sq.mt.	1.90 sq.mt.



FLOOR PLAN - BUILDING A10 & A11



Building	A10 & A11
Floors	G+13
Flat Nos.	101, 102, 103, 104 to 1301, 1302, 1303, 1304
Type	2 BHK
Carpet Area as per RERA	59.20 sq.mt.
Balcony	2.90 sq.mt.
Utility	2.70 sq.mt.



FLOOR PLAN - BUILDING A12

Building	A12
Floors	G+13
Flat Nos.	101, 102, 103, 104, 105, 106 to 1301, 1302, 1303, 1304, 1305, 1306
Type	2 BHK
Carpet Area as per RERA	59.20 sq.mt.
Balcony	2.90 sq.mt.
Utility	2.70 sq.mt.



FLOOR PLAN - BUILDING A13 & A14

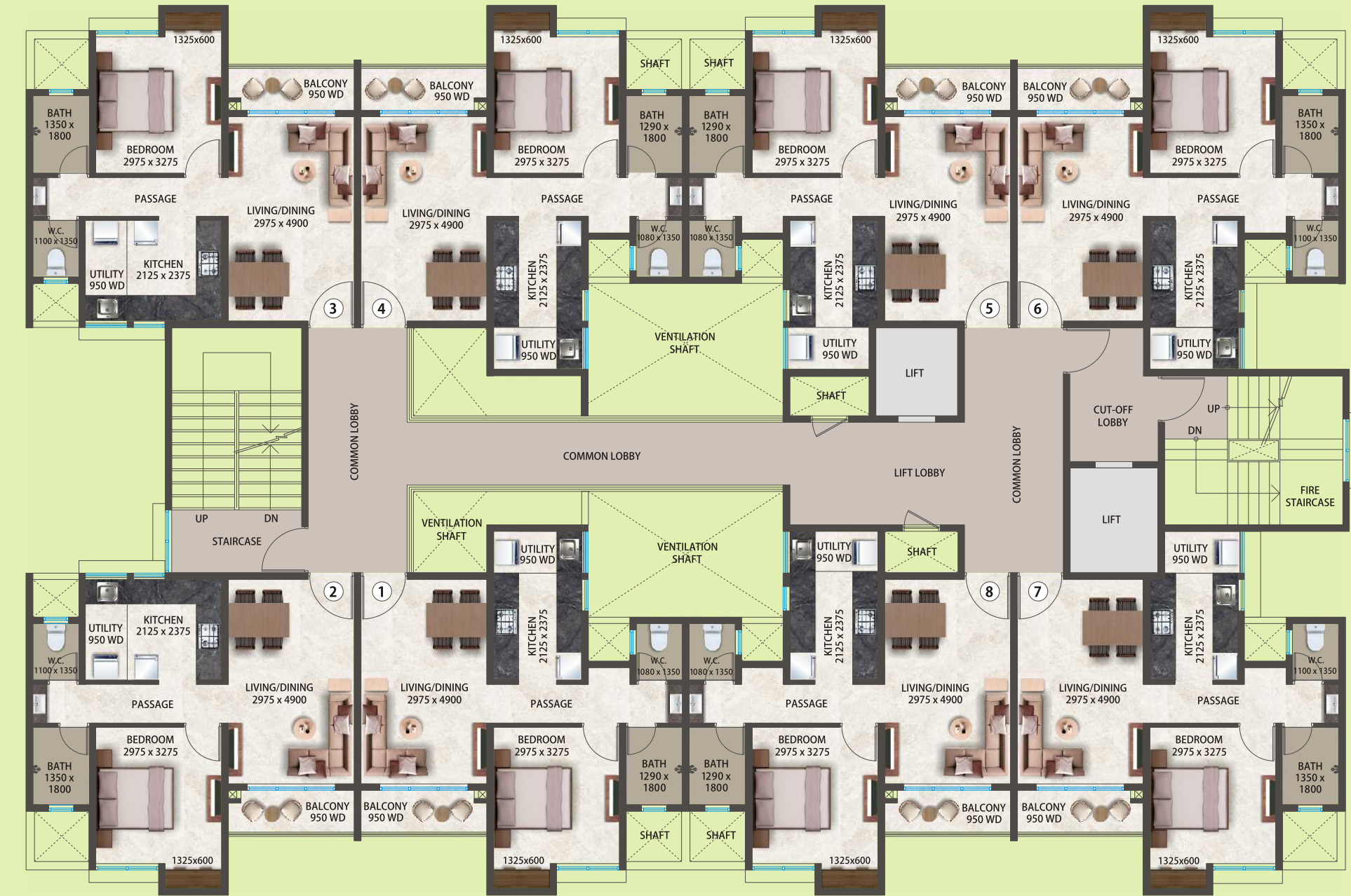

Building	A13 & A14
Floors	G+14
Flat Nos.	101, 102, 103, 104, 105, 106, 107, 108 to 1401, 1402, 1403, 1404, 1405, 1406, 1407, 1408
Type	1 BHK
Carpet Area as per RERA	41.30 sq.mt.
Balcony	2.80 sq.mt.
Utility	2.20 sq.mt.



UNIT PLANS

2 BHK APARTMENT BUILDING - A10, A11 & A12



1 BHK APARTMENT BUILDING - A13 & A14



TYPE-1

TYPE-2



Artist's Impression
Proposed commercial shown in the image is not open for sale as of now and has not been registered with MahaRERA.